

INDUSTRIAL COLLECTION

60" INDUSTRIAL VANITY WITH CONCRETE RECTANGLE SINK

SKU: IND-60N

- Size: 60" x 21" x 35" / RC-4812 Sink ID: 48" x 13" x 5"
- 8 concrete color options and 3 metal finishes
- 6" tailpiece included in Polished Chrome - available in 2 other finishes
- Standard Faucet & Soap Hole Configurations (customizable):
 - 0 Holes: wall-mount faucet
 - 1 single faucet hole or triple-hole set: centered on sink basin
 - 2 single faucet holes or triple-hole sets: centered 10" in from left & right of sink basin
 - Triple-hole set = 8" spread
 - Hole diameter = 1 3/8"
 - Hole(s) centered 2 1/4" off back of sink basin
 - Soap hole(s) (optional): 5" minimum to left or right of faucet hole(s)
- Sink does not have overflow hole
- Handmade in the USA

CONCRETE COLORS



STEEL BASE FINISH



PLAN VIEW

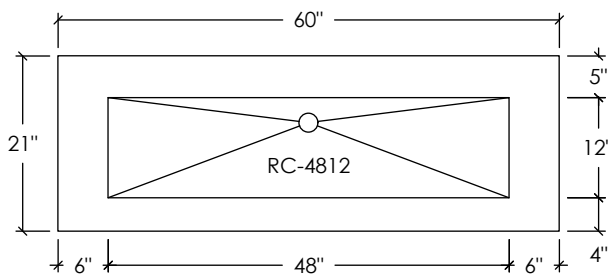

FRONT ELEVATION

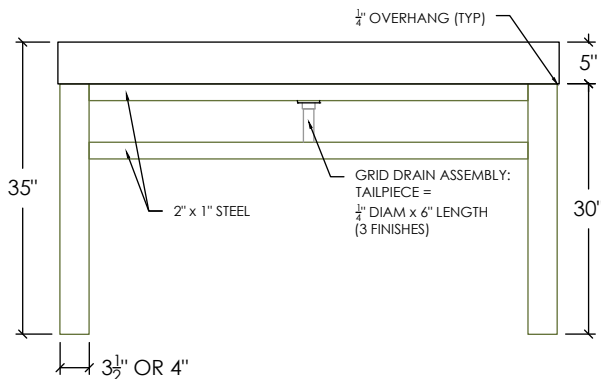

RIGHT ELEVATION

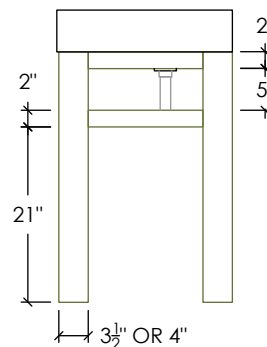

SECTION VIEW

